

D&D Valve & Engineering Supplies (Pty) Ltd

(+2711) 493-1842/3 (8 lines)

sales@ddvalve.co.za

www.ddvalve.co.za

info@ddvalve.co.za

PN25 BRONZE SCREWED LIFT CHECK VALVE

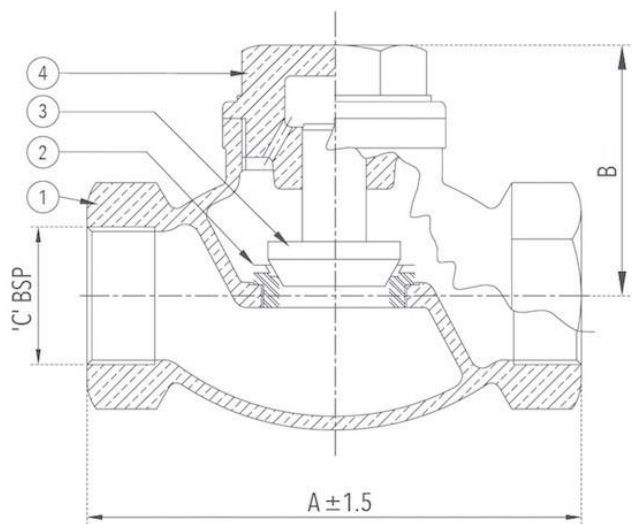

1. Suitable for 10 bar steam @ 180°C
2. Screwed-in cover
3. SS trim
4. Screwed BSP female, parallel threads
5. Hydraulic test pressures:

Body - 37.5 bar

Seat - 27.5 bar

MATERIALS LIST

1	Body	Bronze
2	Seat Ring	SS410
3	Disc	SS410
4	Cover	Bronze

DIMENSIONS

C	A	B
15	70	57
20	80	60
25	93	68
32	106	70
40	119	75
50	142	81